

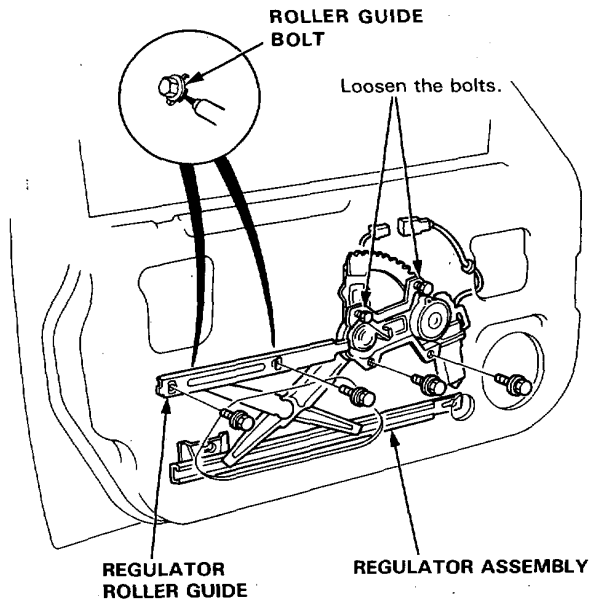

15. Remove the 4 mounting bolts and loosen the 2 motor bolts, then take out the regulator assembly through the center hole in the door.

NOTE: Scribe a line around the roller guide mounting bolt to show the original adjustment.



16. Remove the screw and, starting at the rear, pry the molding up, detach the clips, then remove the outer molding.

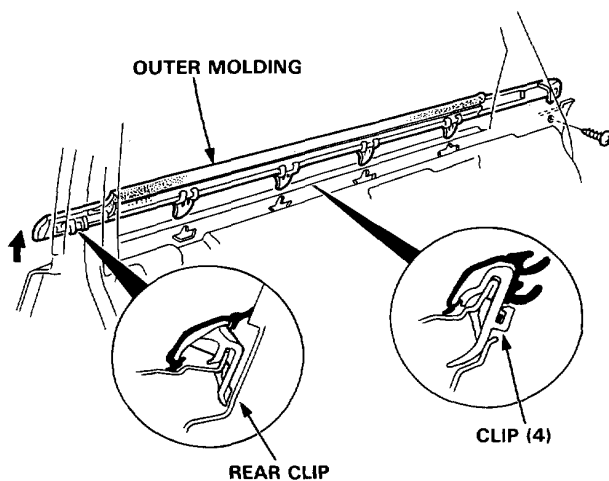

17. Remove the mounting bolts, then remove the front and center channels.

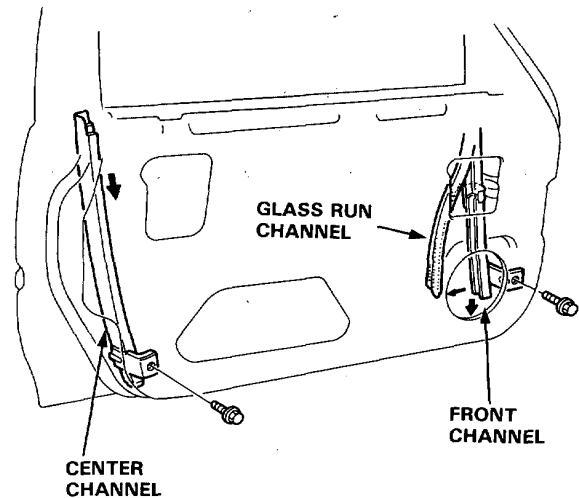

18. Peel off the glass run channel and remove the mounting screws, then remove the door sash garnish by hand.

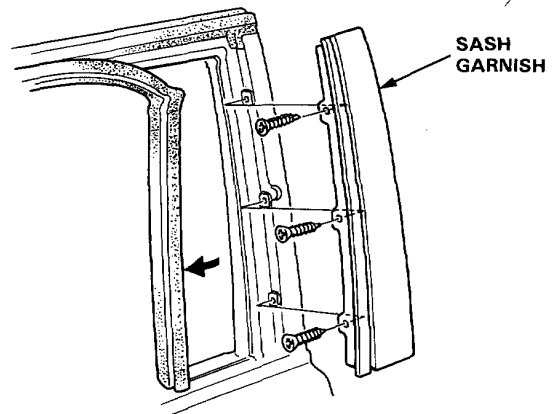

Door

Disassembly

Rear:

1. If applicable, remove the regulator handle by pulling the clip out with a wire hook (page 14-5).
2. Remove the inside door handle and disconnect the latch rod.
3. Remove the screws and detach the clips attaching the door panel. (See door panel release tool, page 14-5).
4. Disconnect the power window and courtesy light harnesses.

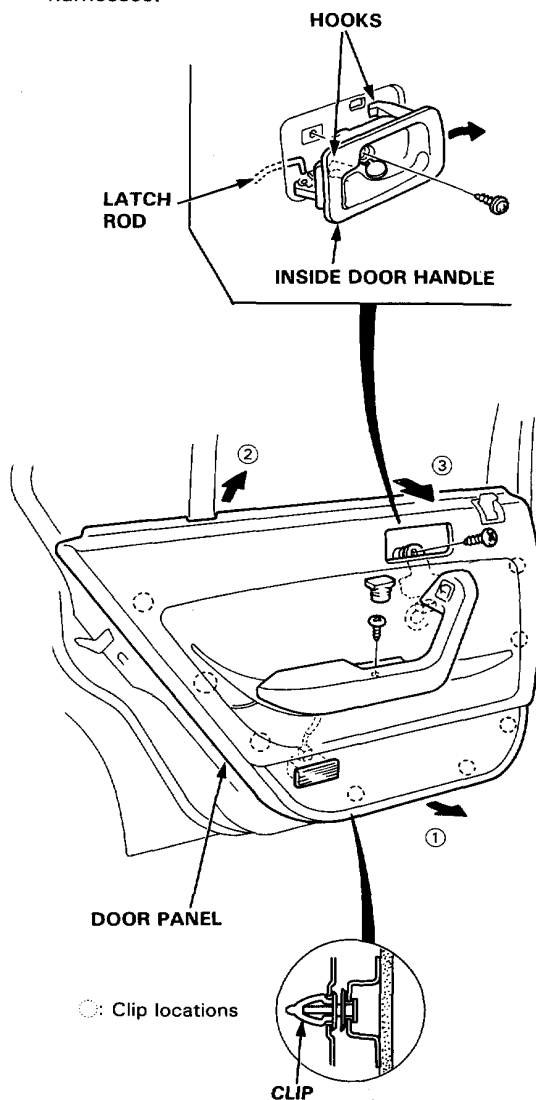

5. Remove the door panel bracket and carefully remove the plastic cover.

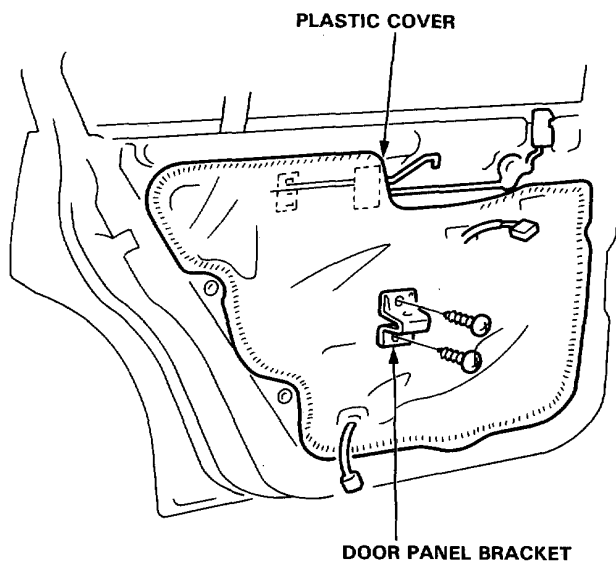

6. Remove the screw attaching the door lock crank. Disconnect the latch rod from the latch side.

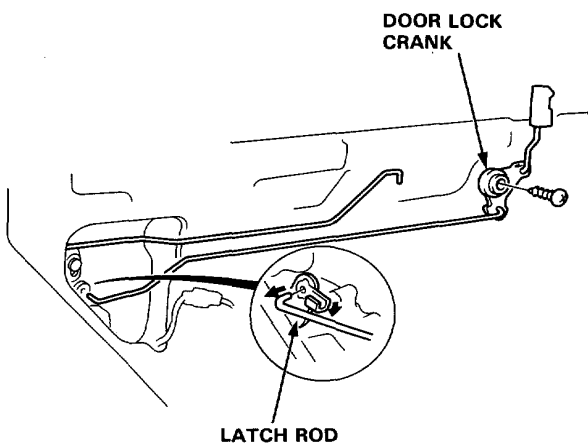



7. Reconnect the window switch or use a 12V battery to operate the window regulator.
8. Roll up the window fully.
9. Use protective tape around the edge of the door handle to prevent scratching the paint. Remove the 3 mounting screws, then slide the latch assembly down.
10. Remove the outside door handle mounting bolts.

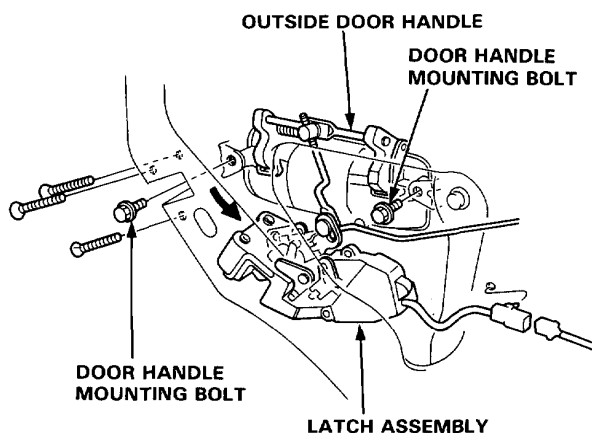

NOTE: Take care not to bend the latch rods.

11. Pull the outside door handle out, and pry the joint off the handle with a flat tip screwdriver. Remove the handle from the rod.

NOTE: To ease reassembly, note the location **A** of the rod on the joint before disconnecting it.

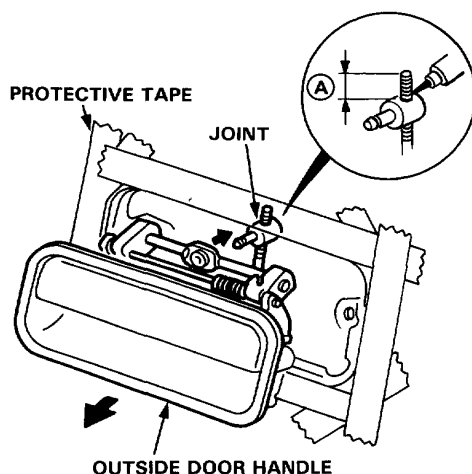

12. Pull the latch assembly out through the hole in the door panel.

13. Carefully lower the window until you can see its mounting bolts.

Use protective tape on the lower door sash garnish and center channel as shown.

Remove the lower bolt from the front channel and slide the channel forward.

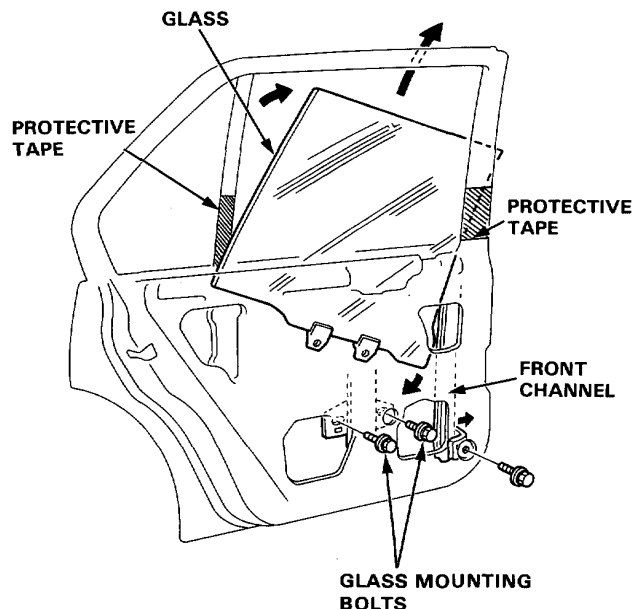

14. Remove the mounting bolts and pull the glass out through the window slot.

15. Remove the 5 regulator mounting bolts and loosen the upper bolt, then take out the regulator assembly through the hole in the door.

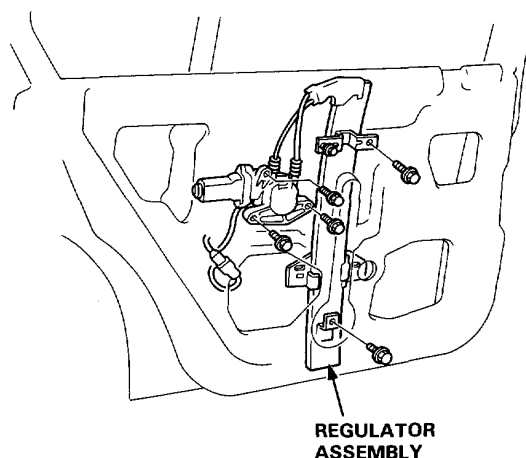

(cont'd)

Doors

Disassembly (cont'd)

16. Starting at the rear, pry the molding up and detach the clips, then remove the outer molding.

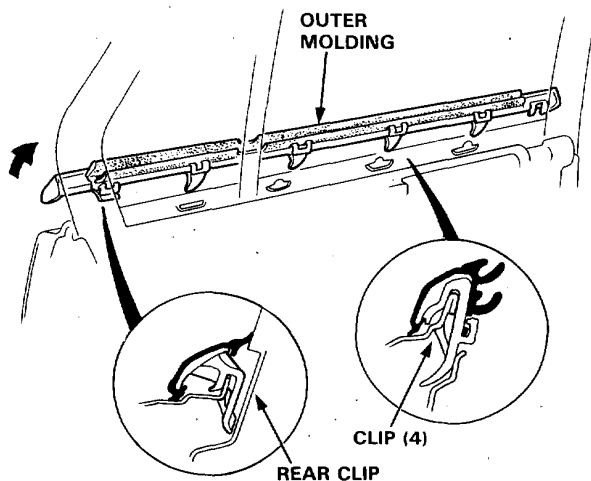

17. Peel off the door weatherstrip and remove the center channel upper mounting screws.
18. Remove the lower mounting bolts and glass run channel, then remove the center channel.
19. Remove the front channel.

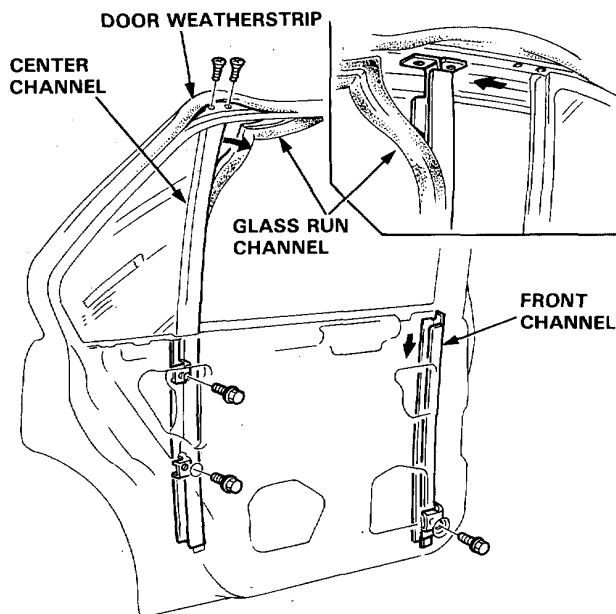

NOTE: When installing the center channel, make sure there is no gap between center channel and quarter glass.

20. Peel off the door weatherstrip.

21. Remove the quarter glass from the door sash.

NOTE: Take care not to scratch or score the glass and molding.

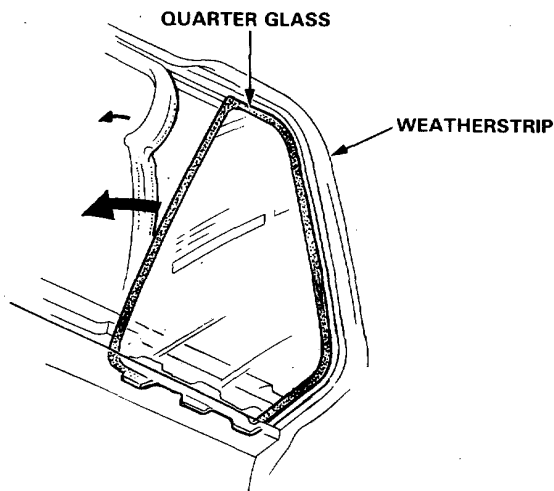

22. Remove the rear door sash garnish in the same way as the front door sash garnish (page 14-7).



*: 40 mm (1.6 in)

14-11

Doors

Assembly

Assemble the door in the reverse order of disassembly, and also:

1. Grease all the sliding surfaces of the window regulator where shown.
2. Before removing the motor, make the location by marking line across the sector gear and regulator, and install using the three mounting bolts. Move the window regulator to the original position by connecting a 12V battery to the motor (See section 16).

Front:

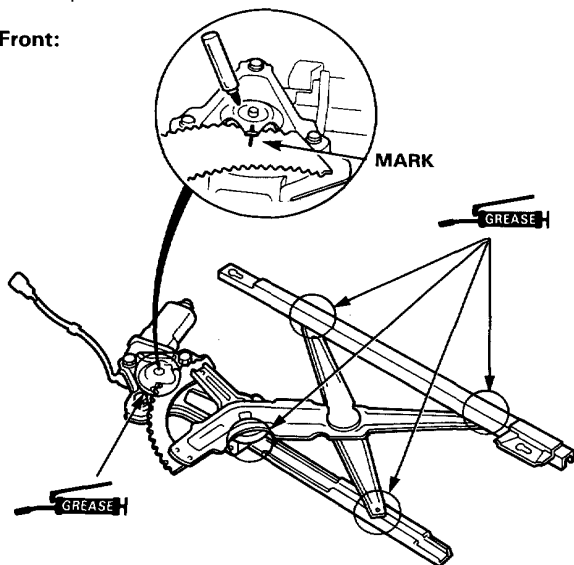

Rear:

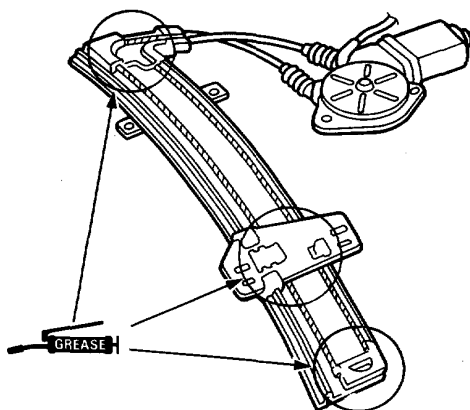

3. Roll the glass up and down to see if it moves freely without binding. Also make sure that there is no clearance between the glass and glass run channel when the glass is closed. Adjust the position of the door glass as necessary (page 14-13).

4. Fix the wire harness correctly on the door.

5. When reinstalling the plastic cover, apply adhesive along the edge where necessary to maintain a continuous seal and prevent air/water leaks.

Front:

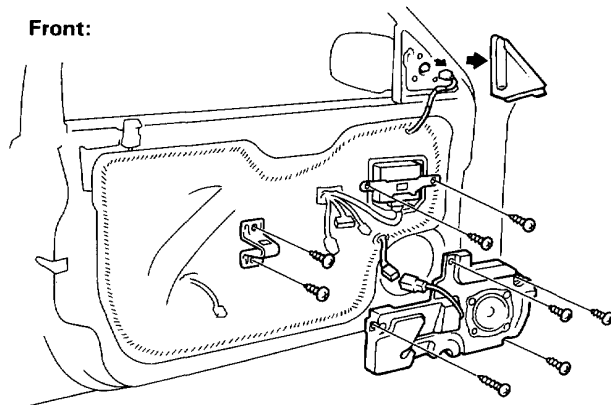

Rear:

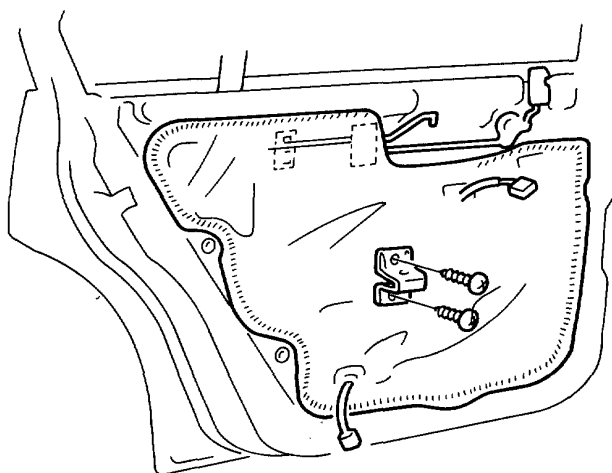

6. Install the regulator handle so it points forward and up at a 45 degree angle with the window closed.

